



Madison Park Technical Vocational High School Community Meeting – June 21, 2023

annum



newvistadesign

CITY of BOSTON



Public Facilities

Meeting Agenda

1. Welcome
2. Study Timeline
3. Educational Plan
4. Advisory Board
5. Program Analysis
6. Concepts for Pricing
7. Next Steps
8. Closing Remarks



Study Timeline

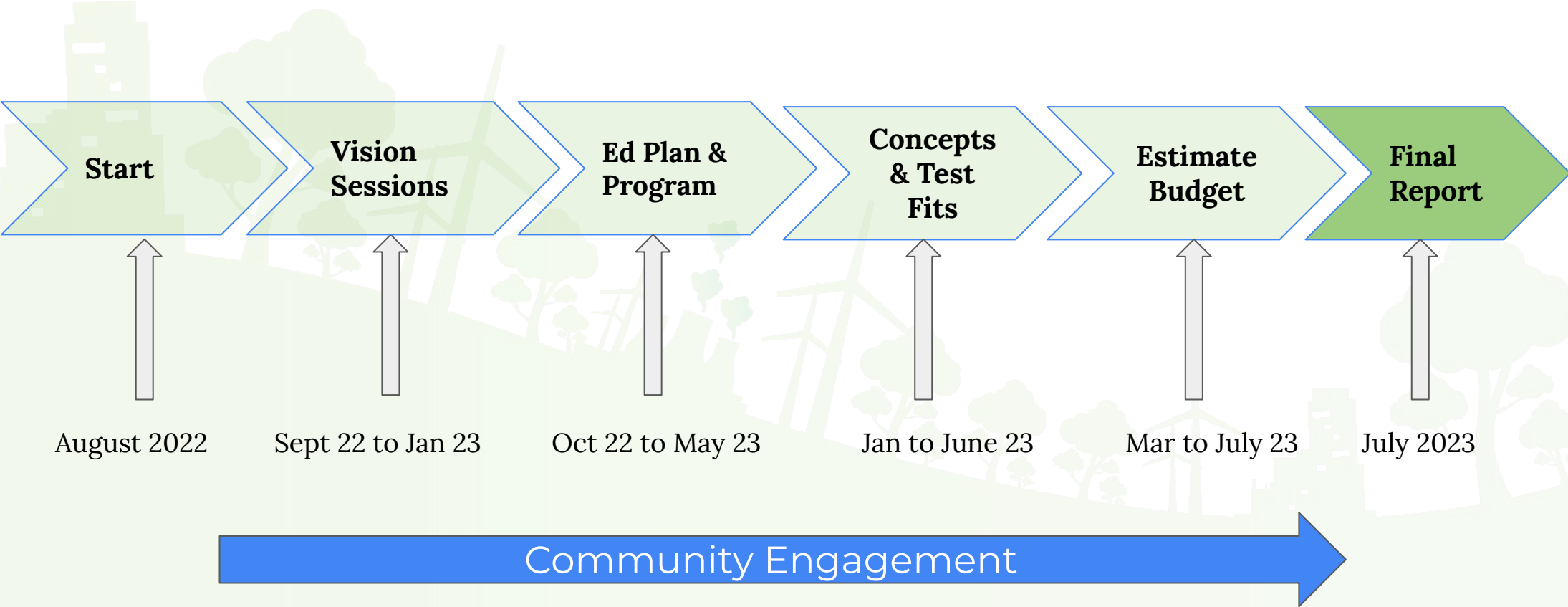

Educational Transformation at Madison Park

- **Dr. Lindsa McIntyre**
BPS Secondary School
Superintendent
- **Dr. Sidney Brown**
Madison Park Head of School
- **Artis C. Street**
Madison Park Assistant School
Leader



Project and Problem-Based Learning

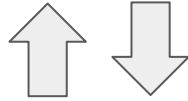

High-quality Career
Vocational Technical
Education focused on green
industries and economy

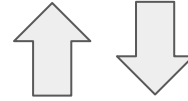

Integrated Traditional
Academics with CVTE
content through strategic
adjacencies

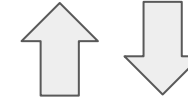

Student Support and Social
Emotional Learning
Embedded into academic
clusters

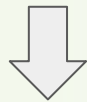

Focus and Attention to Community
(internships, jobs, mentors, learning by doing, access for community)

Key Elements of Ed Plan

Focused CTE and Academic Programming

- **Green Industries and Practices as unifying CTE theme:** Renewed focus on innovative Career Technical Education (CTE) learning experiences, and integration of green industries and energy across all CTE programs.
- **New CTE Programs:** Student exposure to high-demand industries, including environmental science and technology, early childhood education, aviation technology, biotechnology and robotics.
- **Integration of Learning:** Core academic disciplines alongside strategically adjacent CTE programs to foster and support interdisciplinary projects and project-based learning.
 - Humanities & Language Arts Cluster
 - Science, Technology, Engineering, Art & Math (STEAM) Cluster
 - Health & Wellness Cluster

Key Elements of Ed Plan

Innovative Programming Supported by Community

- **New academic programs:** World Languages (with a language lab embedded in the Learning Commons/Media Center) and state-of-the-art Fine and Performing Arts instructional spaces.
- **Embedded Student Supports:** Social-emotional student supports and student services (e.g., SE, ESL and SEL) embedded into academic/CTE clusters to ensure strong and comprehensive Tier 1 instruction.
- **Community:** Opportunities for the community to learn from and participate in the educational experiences offered at Madison Park, and to lend their skills and talents as a source of learning and opportunity for Madison Park students.
- **Expand to 7-12:** Expansion of grade configuration to include 7th and 8th grades and incorporation of two Pre-Kindergarten classrooms to support new proposed Early Education and Care CTE program.

Greater Boston Vo-Tech Tours

Essex North Shore Agricultural + Technical School (ENSAT)
Somerville High School



One of three dispersed dining areas at ENSAT



Enclosed courtyard at Somerville High School offers secure outdoor areas



ENSAT's advanced manufacturing shop



ENSAT's Media Center supports students with flexible meeting spaces and is available to the public as a lecture spaces

Comparative Analysis of MPTHVS Programs to Local Vocational-Technical Schools

Study by MASS Insight

School (Enrollment)	Madison Park VTHS (985)	Blue Hills RVTHS (890)	Tri County RVTHS (953)	Worcester THS (1199)	Assabet Valley VHS (1149)	Providence CTA (654) ⁷
Automotive Technology	X		X	X	X	X
Biotechnology	X			X	X	
Business Management, Accounting and Finance	X	X		X	X	
Cosmetology	X		X	X	X	X
Culinary Arts	X		X	X	X	X
Digital Arts & Graphic Design	X	X	X		X	X
Education/Early Childhood	X	X	X	X		
Environmental Technology				X		
Engineering Technology			X		X	X
Fabrication/Manufacturing	X		X	X	X	X
Healthcare (incl. Dental Tech)	X	X	X	X	X	
Interior Design				X	X	
Legal/Criminal Justice		X	X			
Project Management & Quality Assurance		X				
Robotics and Automation	X			X		
Skilled Trades (Carpentry, Diesel Tech, HVAC, Welding, Plumbing, Electrical)	X	X	X	X	X	X
Software, IT & Web Development	X	X	X	X	X	
Veterinary Assisting				X		

Building Opportunity Through Career Pipelines

- We are in a different era for vocational/technical education. We will take advantage of that by building the best and most extensive voc/tech school in Massachusetts with opportunities that do not exist anywhere else. The full campus will be dedicated to vocational/technical education opportunities.
- Steering Committee comprising business, labor, and community will tackle three goals:
 - Review program advisory boards – which programs make sense in today’s economy? Which programs don’t? Which programs should be added? How should they be structured?
 - Renew general advisory council to meet regularly
 - Build opportunity by recruiting new industries, employers, unions, and more (Jet Blue).
 - Commit to making MP a focal point for adult education and career advancement
- MP’s campus will generate opportunity not only for students and adults in education and career training, but for all kinds of services.

CTE Groups

GROUP 1

Arts + Communications Cluster

Design and Visual Communications

Graphic Communications

Radio + Television Broadcasting

Business and Service Cluster

Cosmetology

Marketing

Early Childhood Education + Care

GROUP 2

Construction Cluster

Carpentry

Electricity

Facilities Management

HVAC - R

Plumbing

GROUP 3

Health Services Cluster

Dental Assisting

Health Assisting

Medical Assisting

Hospitality + Tourism Cluster

Culinary Arts

Hospitality Management

GROUP 4

Info Tech Service Cluster

Information Support Services + Networking

Computer Programming + Web Development

Manufacturing, Engineering + Tech Cluster

Metal Fabrication + Joining Tech

Transportation Cluster

Automotive Collision + Repair

Automotive Tech

Aviation Tech

GROUP 5

Advanced Tech Cluster

Biotechnology

Environmental Science + Technology

Robotics + Automation Tech

CTE Groups

26 VOCATIONAL SHOPS AND CLASSROOMS 95,000 NSF



88 ACADEMIC CLASSROOMS AND 19 LABS 130,000 NSF

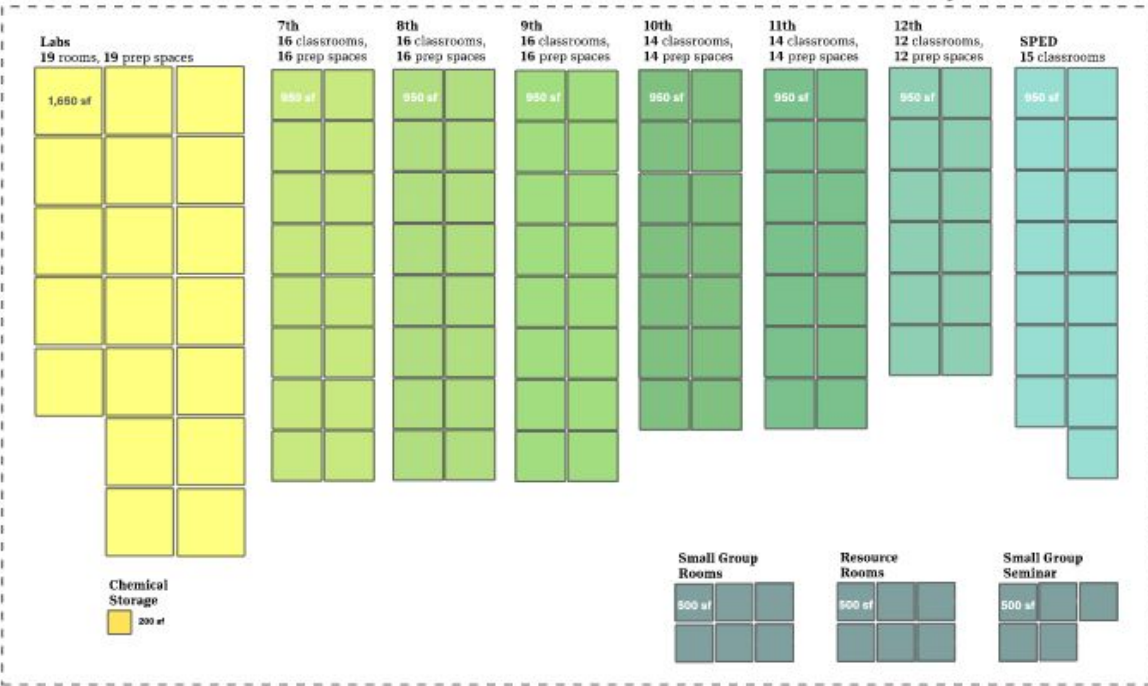

ADMINISTRATION 7,300 NSF

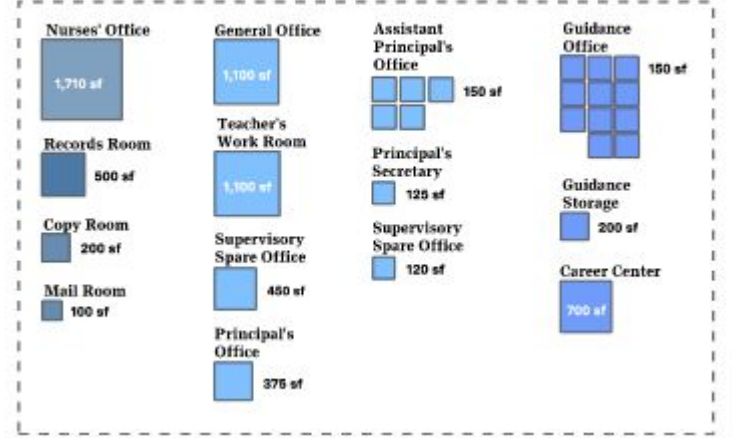

ADDITIONAL PROGRAM 16,000 NSF



MUSIC AND ARTS 10,000 NSF

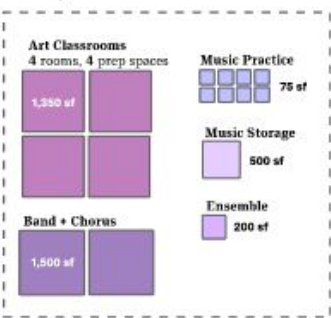

GATHERING 45,000 NSF

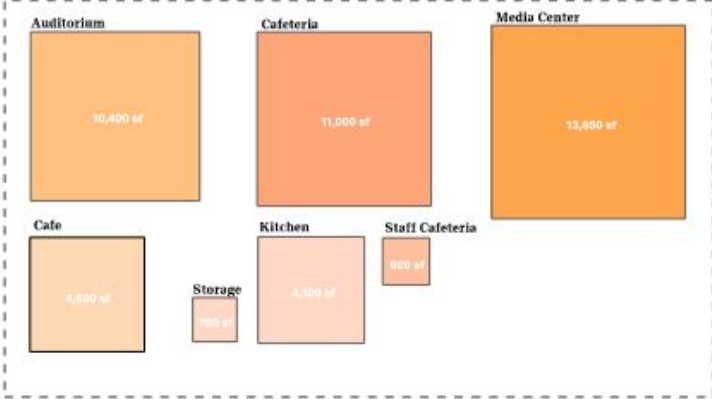

Feasibility Report includes 3 Design Concepts, which...

- are designed to accommodate 2,200 students in grades 7-12
- include all new state-of-the-art Vo-Tech teaching equipment
- offer new spaces for Visual and Performing Arts
- feature increased community access
- include new furniture for all MPTVHS spaces
- have secure outdoor spaces, new plazas + plantings
- are fully accessible, with new code-compliant elevators
- are fully air conditioned, with all new bathrooms and security systems

Option 1

Gut Renovation with New Facades + Infill Addition

- Least Costly
- MPTVHS in Bldg 7,1,2
- New Entrance at improved Bldg 1
- Classrooms in Bldg 2
- Bldg 3,5,6 available for other use

Option 2

Gut Renovation with New Facades, “Stand alone” Prominent Additions + Elevated Courtyard

- Most Costly - Most New Additions
- MPTVHS in Bldg 7,1
- New Entrance Building at Bldg 1
- Community Program on Malcolm X
- Bldg 2,3,5,6 available for other use

Option 3

Gut Renovation with New Facades, Infill Additions + Elevated Courtyard

- Middle Cost
- MPTVHS in Bldg 7,1,2
- New Entrance at improved Bldg 1
- Classrooms in Bldg 2
- Community Program on Malcolm X
- Bldg 3,5,6 available for other use

Option 1



Option 2



Option 3



Next Steps

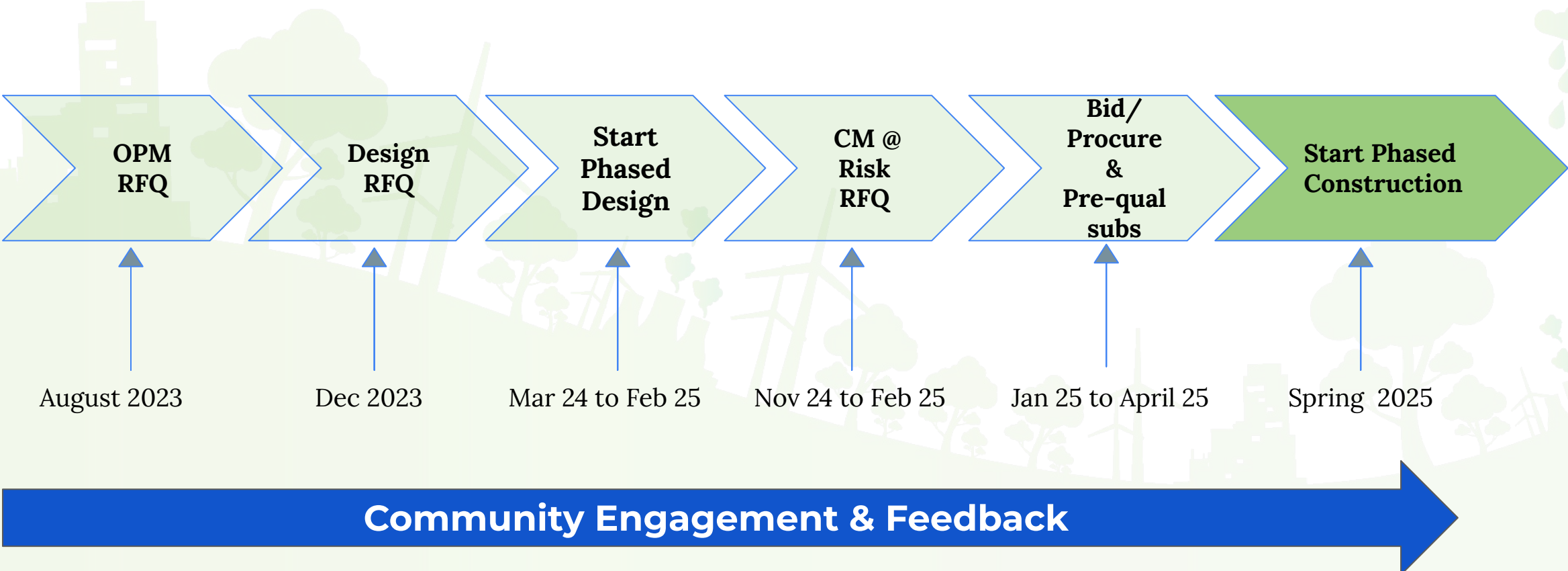

Q&A



Thank you!